

ZONING DISTRICTS

- (RD1)** RESTRICTED DEVELOPMENT
- (RD2)** RESTRICTED DEVELOPMENT
- (R1)** LOW DENSITY RESIDENTIAL
- (R2)** MEDIUM DENSITY RESIDENTIAL
- (R3)** HIGH DENSITY RESIDENTIAL
- (R4)** LARGE LOT ACREAGE RESIDENTIAL
- (R4a)** ACREAGE RESIDENTIAL
- (R5)** MANUFACTURED RESIDENTIAL
- (CS)** COMMUNITY SERVICE
- (C1)** COMMUNITY CENTRE COMMERCIAL
- (C2)** HIGHWAY COMMERCIAL
- (M)** INDUSTRIAL
- (FUD)** FUTURE URBAN DEVELOPMENT

• This is the Zoning District Map which accompanies Bylaw Number _____ adopted by the Town of Battleford.

Mayor _____

City Clerk _____

• Approved on the _____ day of _____ .

Minister
Saskatchewan Government Relations

THE INFORMATION CONTAINED ON THIS MAP HAS BEEN CONSOLIDATED FOR REFERENCE ONLY AND SHOULD NOT BE USED FOR LEGAL PURPOSES.

INDEX PAGE

TOWN OF BATTLEFORD
ZONING DISTRICT MAP

AE PROJECT No.	20224802-00
SCALE	NTS
APPROVED	J. TAYLOR
DATE	2022NOV04
REV	1
DESCRIPTION	UPDATED ZONING MAP INCLUDING ALL BYLAWS APPROVED AS OF SEPT 20, 2022

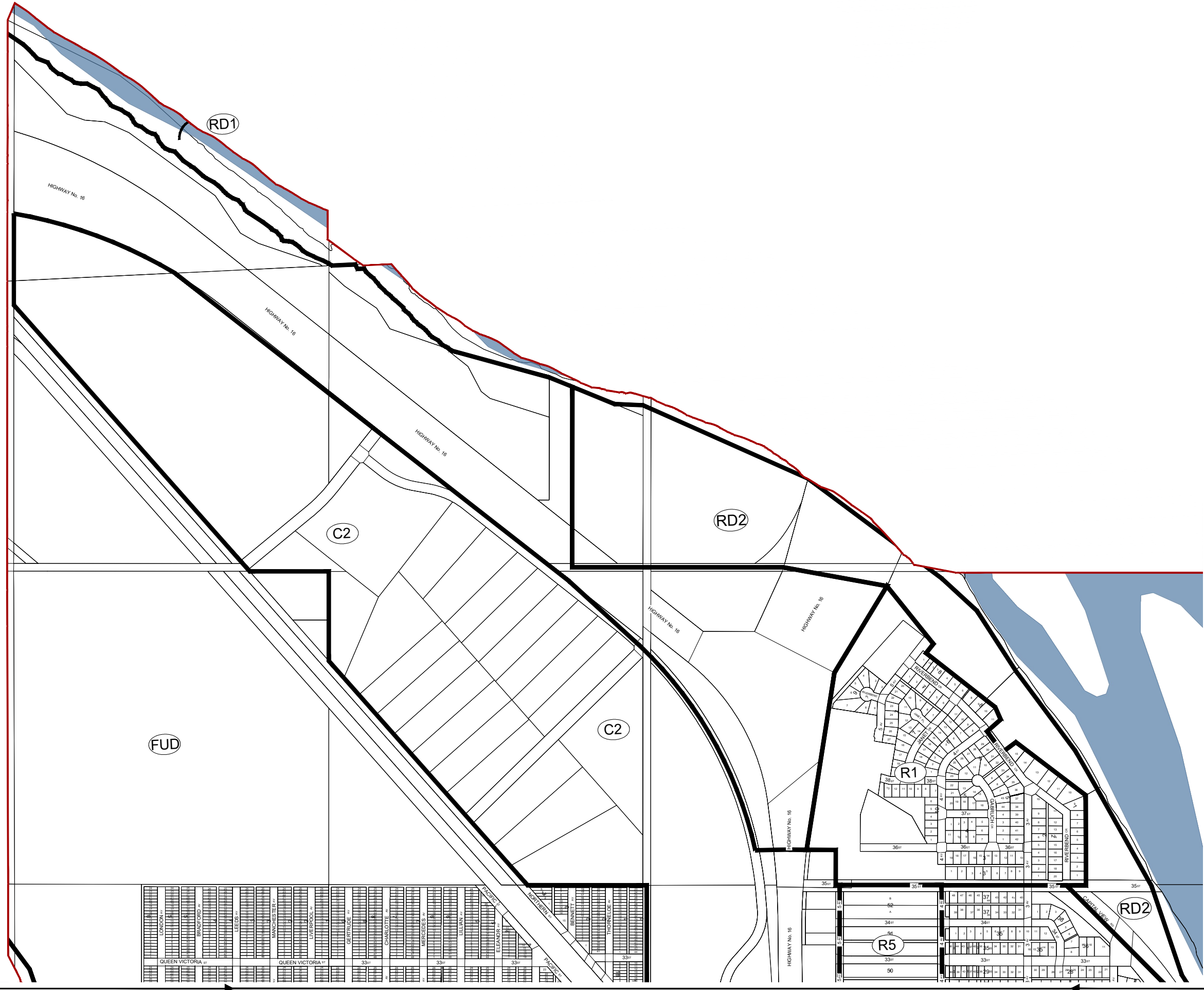

ZONING DISTRICTS

- (RD1)** RESTRICTED DEVELOPMENT
- (RD2)** RESTRICTED DEVELOPMENT
- (R1)** LOW DENSITY RESIDENTIAL
- (R2)** MEDIUM DENSITY RESIDENTIAL
- (R3)** HIGH DENSITY RESIDENTIAL
- (R4)** LARGE LOT ACREAGE RESIDENTIAL
- (R4a)** ACREAGE RESIDENTIAL
- (R5)** MANUFACTURED RESIDENTIAL
- (CS)** COMMUNITY SERVICE
- (C1)** COMMUNITY CENTRE COMMERCIAL
- (C2)** HIGHWAY COMMERCIAL
- (M)** INDUSTRIAL
- (FUD)** FUTURE URBAN DEVELOPMENT

• This is the Zoning District Map which accompanies Bylaw Number _____ adopted by the Town of Battleford.

Mayor _____

City Clerk _____

• Approved on the _____ day of _____ .

Minister
Saskatchewan Government Relations

THE INFORMATION CONTAINED ON THIS MAP HAS BEEN CONSOLIDATED FOR REFERENCE ONLY AND SHOULD NOT BE USED FOR LEGAL PURPOSES.

PAGE 1

TOWN OF BATTLEFORD
ZONING DISTRICT MAP

AE PROJECT No.	20224802-00
SCALE	NTS
APPROVED	J. TAYLOR
DATE	2022NOV04
REV	1
DESCRIPTION	UPDATED ZONING MAP INCLUDING ALL BYLAWS APPROVED AS OF SEPT 20, 2022

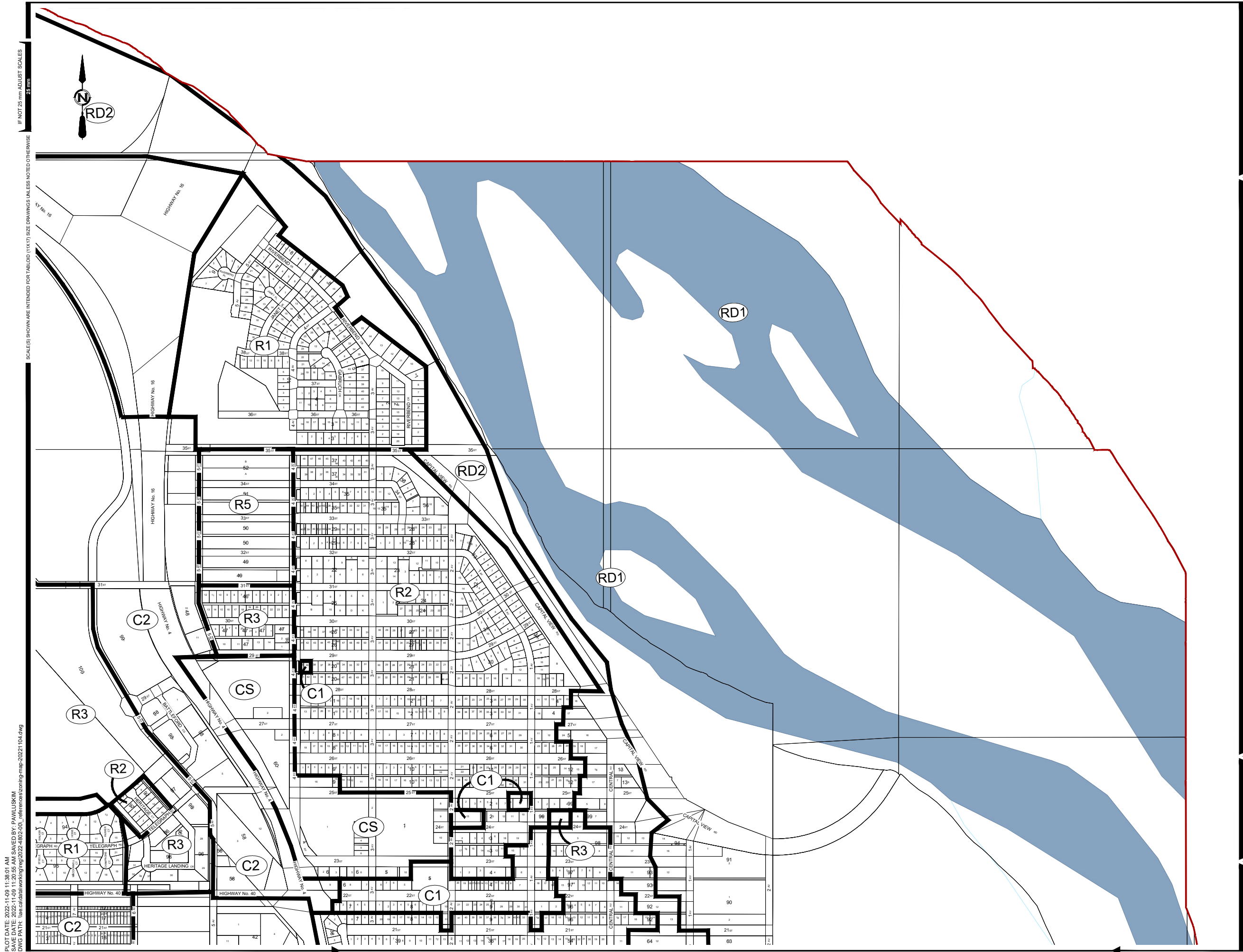

ZONING DISTRICTS

- RD1** RESTRICTED DEVELOPMENT
- RD2** RESTRICTED DEVELOPMENT
- R1** LOW DENSITY RESIDENTIAL
- R2** MEDIUM DENSITY RESIDENTIAL
- R3** HIGH DENSITY RESIDENTIAL
- R4** LARGE LOT ACREAGE RESIDENTIAL
- R4a** ACREAGE RESIDENTIAL
- R5** MANUFACTURED RESIDENTIAL
- CS** COMMUNITY SERVICE
- C1** COMMUNITY CENTRE COMMERCIAL
- C2** HIGHWAY COMMERCIAL
- M** INDUSTRIAL
- FUD** FUTURE URBAN DEVELOPMENT

• This is the Zoning District Map which accompanies Bylaw Number _____ adopted by the Town of Battleford.

Mayor _____

City Clerk _____

• Approved on the _____ day of _____

Minister
Saskatchewan Government Relations

THE INFORMATION CONTAINED ON THIS MAP HAS BEEN CONSOLIDATED FOR REFERENCE ONLY AND SHOULD NOT BE USED FOR LEGAL PURPOSES.

PAGE 2

TOWN OF BATTLEFORD
ZONING DISTRICT MAP

AE PROJECT No.	20224802-00
SCALE	NTS
APPROVED	J. TAYLOR
DATE	2022NOV04
REV	1
DESCRIPTION	UPDATED ZONING MAP INCLUDING ALL BYLAWS APPROVED AS OF SEPT 20, 2022

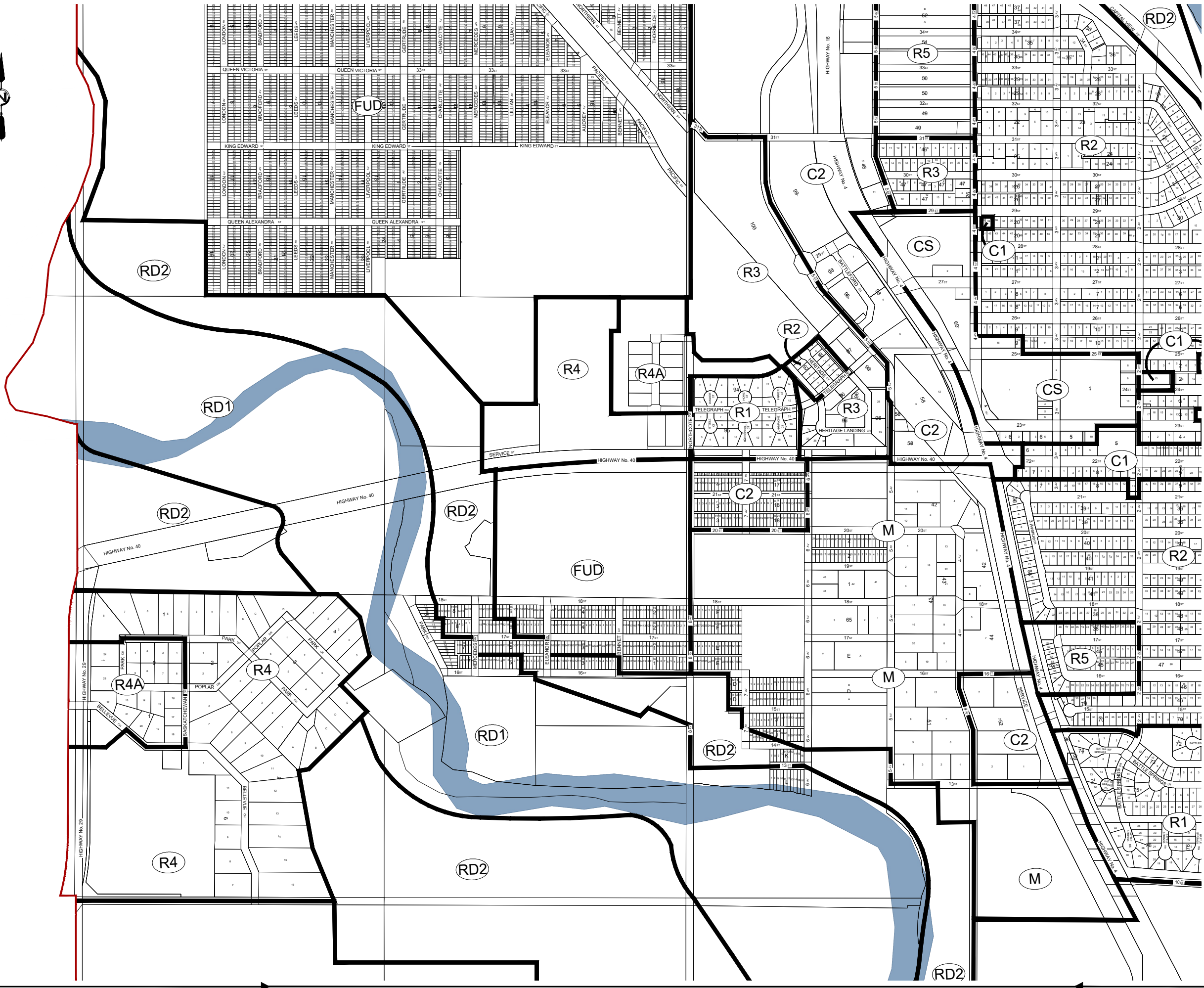

ZONING DISTRICTS

- (RD1) RESTRICTED DEVELOPMENT
- (RD2) RESTRICTED DEVELOPMENT
- (R1) LOW DENSITY RESIDENTIAL
- (R2) MEDIUM DENSITY RESIDENTIAL
- (R3) HIGH DENSITY RESIDENTIAL
- (R4) LARGE LOT ACREAGE RESIDENTIAL
- (R4a) ACREAGE RESIDENTIAL
- (R5) MANUFACTURED RESIDENTIAL
- (CS) COMMUNITY SERVICE
- (C1) COMMUNITY CENTRE COMMERCIAL
- (C2) HIGHWAY COMMERCIAL
- (M) INDUSTRIAL
- (FUD) FUTURE URBAN DEVELOPMENT

• This is the Zoning District Map which accompanies Bylaw Number adopted by the Town of Battleford.

Mayor _____

City Clerk _____

• Approved on the _____ day of _____

Minister
Saskatchewan Government Relations

THE INFORMATION CONTAINED ON THIS MAP HAS BEEN CONSOLIDATED FOR REFERENCE ONLY AND SHOULD NOT BE USED FOR LEGAL PURPOSES.

PAGE 3

TOWN OF BATTLEFORD
ZONING DISTRICT MAP

AE PROJECT No.	20224802-00
SCALE	NTS
APPROVED	J. TAYLOR
DATE	2022NOV04
REV	1
DESCRIPTION	UPDATED ZONING MAP INCLUDING ALL BYLAWS APPROVED AS OF SEPT 20, 2022

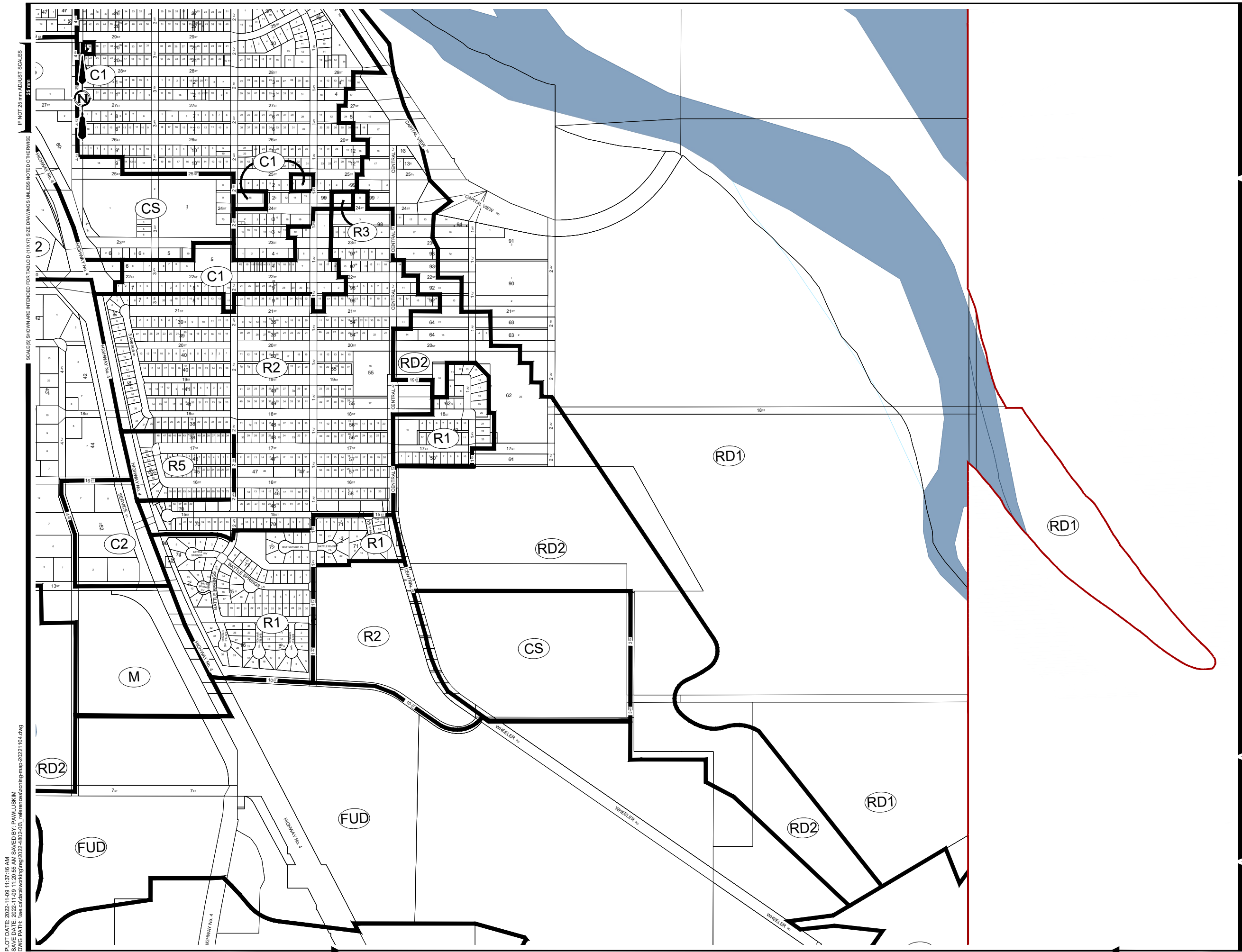

ZONING DISTRICTS

- (RD1)** RESTRICTED DEVELOPMENT
- (RD2)** RESTRICTED DEVELOPMENT
- (R1)** LOW DENSITY RESIDENTIAL
- (R2)** MEDIUM DENSITY RESIDENTIAL
- (R3)** HIGH DENSITY RESIDENTIAL
- (R4)** LARGE LOT ACREAGE RESIDENTIAL
- (R4a)** ACREAGE RESIDENTIAL
- (R5)** MANUFACTURED RESIDENTIAL
- (CS)** COMMUNITY SERVICE
- (C1)** COMMUNITY CENTRE COMMERCIAL
- (C2)** HIGHWAY COMMERCIAL
- (M)** INDUSTRIAL
- (FUD)** FUTURE URBAN DEVELOPMENT

• This is the Zoning District Map which accompanies Bylaw Number _____ adopted by the Town of Battleford.

Mayor _____

City Clerk _____

• Approved on the _____ day of _____ .

Minister
Saskatchewan Government Relations

THE INFORMATION CONTAINED ON THIS MAP HAS BEEN CONSOLIDATED FOR REFERENCE ONLY AND SHOULD NOT BE USED FOR LEGAL PURPOSES.

PAGE 4

TOWN OF BATTLEFORD
ZONING DISTRICT MAP

AE PROJECT No.	20224802-00
SCALE	NTS
APPROVED	J. TAYLOR
DATE	2022NOV04
REV	1
DESCRIPTION	UPDATED ZONING MAP INCLUDING ALL BYLAWS APPROVED AS OF SEPT 20, 2022

PLOT DATE: 2022-11-09 11:36:54 AM
SAVE DATE: 2022-11-09 11:20:55 AM
DWG PATH: \\ae.ca\data\working\res\2022-4802-00_references\zoning-map-20221104.dwg

IF NOT 25 mm ADJUST SCALES
SCALE(S) SHOWN ARE INTENDED FOR TABLOID (11X17) SIZE DRAWINGS UNLESS NOTED OTHERWISE

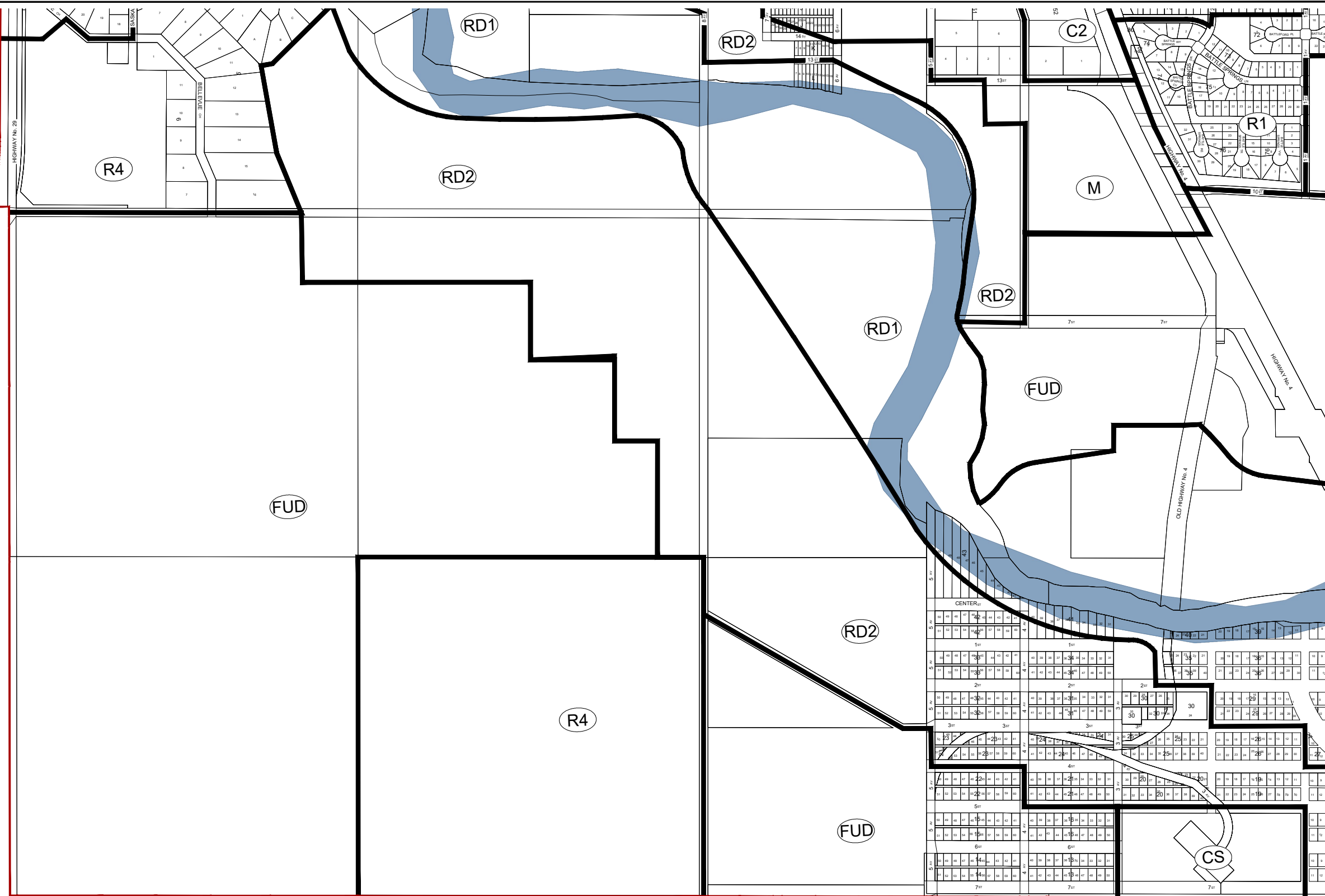

ZONING DISTRICTS

- (RD1) RESTRICTED DEVELOPMENT
- (RD2) RESTRICTED DEVELOPMENT
- (R1) LOW DENSITY RESIDENTIAL
- (R2) MEDIUM DENSITY RESIDENTIAL
- (R3) HIGH DENSITY RESIDENTIAL
- (R4) LARGE LOT ACREAGE RESIDENTIAL
- (R4a) ACREAGE RESIDENTIAL
- (R5) MANUFACTURED RESIDENTIAL
- (CS) COMMUNITY SERVICE
- (C1) COMMUNITY CENTRE COMMERCIAL
- (C2) HIGHWAY COMMERCIAL
- (M) INDUSTRIAL
- (FUD) FUTURE URBAN DEVELOPMENT

• This is the Zoning District Map which accompanies Bylaw Number _____ adopted by the Town of Battleford.

Mayor _____

City Clerk _____

• Approved on the _____ day of _____

Minister
Saskatchewan Government Relations

THE INFORMATION CONTAINED ON THIS MAP HAS BEEN CONSOLIDATED FOR REFERENCE ONLY AND SHOULD NOT BE USED FOR LEGAL PURPOSES.

PAGE 5

TOWN OF BATTLEFORD
ZONING DISTRICT MAP

AE PROJECT No.	20224802-00
SCALE	NTS
APPROVED	J. TAYLOR
DATE	2022NOV04
REV	1
DESCRIPTION	UPDATED ZONING MAP INCLUDING ALL BYLAWS APPROVED AS OF SEPT 20, 2022

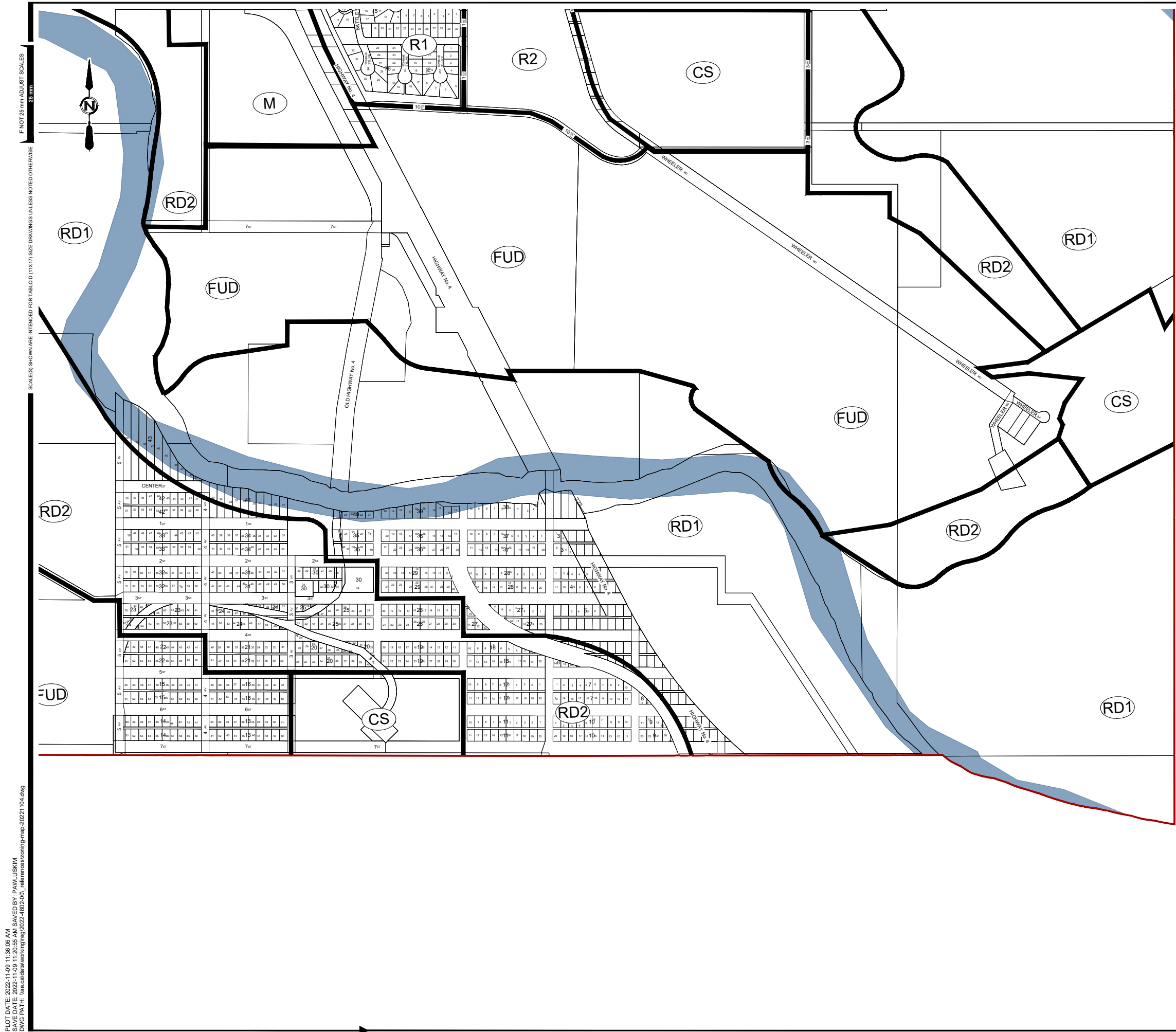

ZONING DISTRICTS

- RD1** RESTRICTED DEVELOPMENT
- RD2** RESTRICTED DEVELOPMENT
- R1** LOW DENSITY RESIDENTIAL
- R2** MEDIUM DENSITY RESIDENTIAL
- R3** HIGH DENSITY RESIDENTIAL
- R4** LARGE LOT ACREAGE RESIDENTIAL
- R4a** ACREAGE RESIDENTIAL
- R5** MANUFACTURED RESIDENTIAL
- CS** COMMUNITY SERVICE
- C1** COMMUNITY CENTRE COMMERCIAL
- C2** HIGHWAY COMMERCIAL
- M** INDUSTRIAL
- FUD** FUTURE URBAN DEVELOPMENT

• This is the Zoning District Map which accompanies Bylaw Number _____ adopted by the Town of Battleford.

Mayor _____

City Clerk _____

• Approved on the _____ day of _____

Minister
Saskatchewan Government Relations

THE INFORMATION CONTAINED ON THIS MAP HAS BEEN CONSOLIDATED FOR REFERENCE ONLY AND SHOULD NOT BE USED FOR LEGAL PURPOSES.

AE PROJECT No.	20224802-00
SCALE	NTS
APPROVED	J. TAYLOR
DATE	2022NOV04
REV	1
DESCRIPTION	UPDATED ZONING MAP INCLUDING ALL BYLAWS APPROVED AS OF SEPT 20, 2022